

Project Information		Approval	
Project Name	[Illegible]	Prepared by	[Illegible]
Client	[Illegible]	Checked by	[Illegible]
Date	[Illegible]	Approved by	[Illegible]
Scale	[Illegible]	Scale	[Illegible]

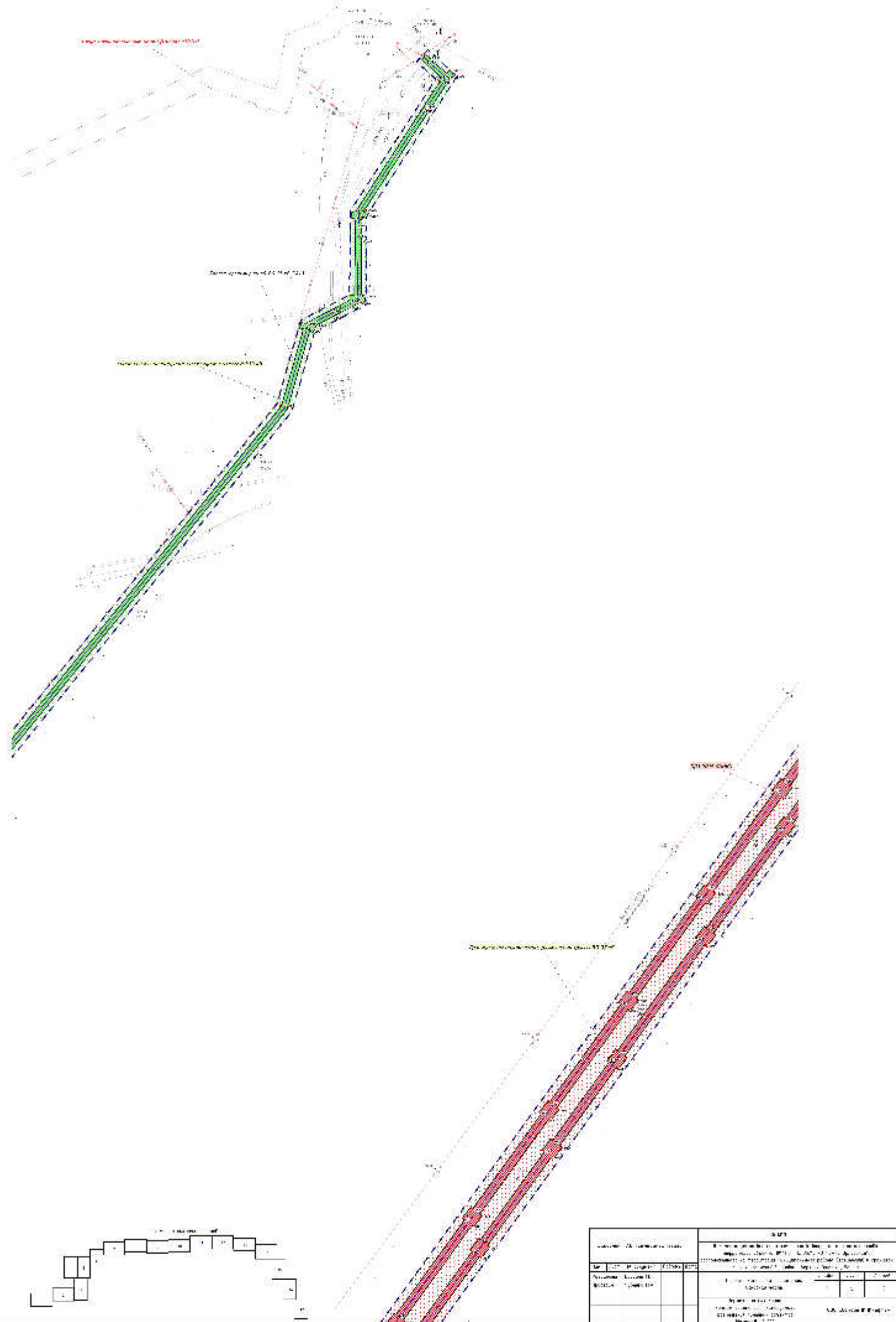

Project Information		Scale	
Project No.	2014-00000000	Scale	1" = 40'
Revision	1	Scale	1" = 40'
Author	...	Scale	1" = 40'
Checker	...	Scale	1" = 40'
Appr.	...	Scale	1" = 40'
Date	...	Scale	1" = 40'

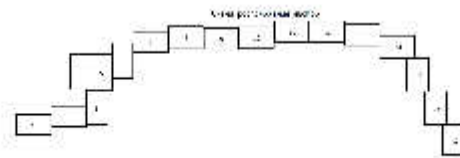
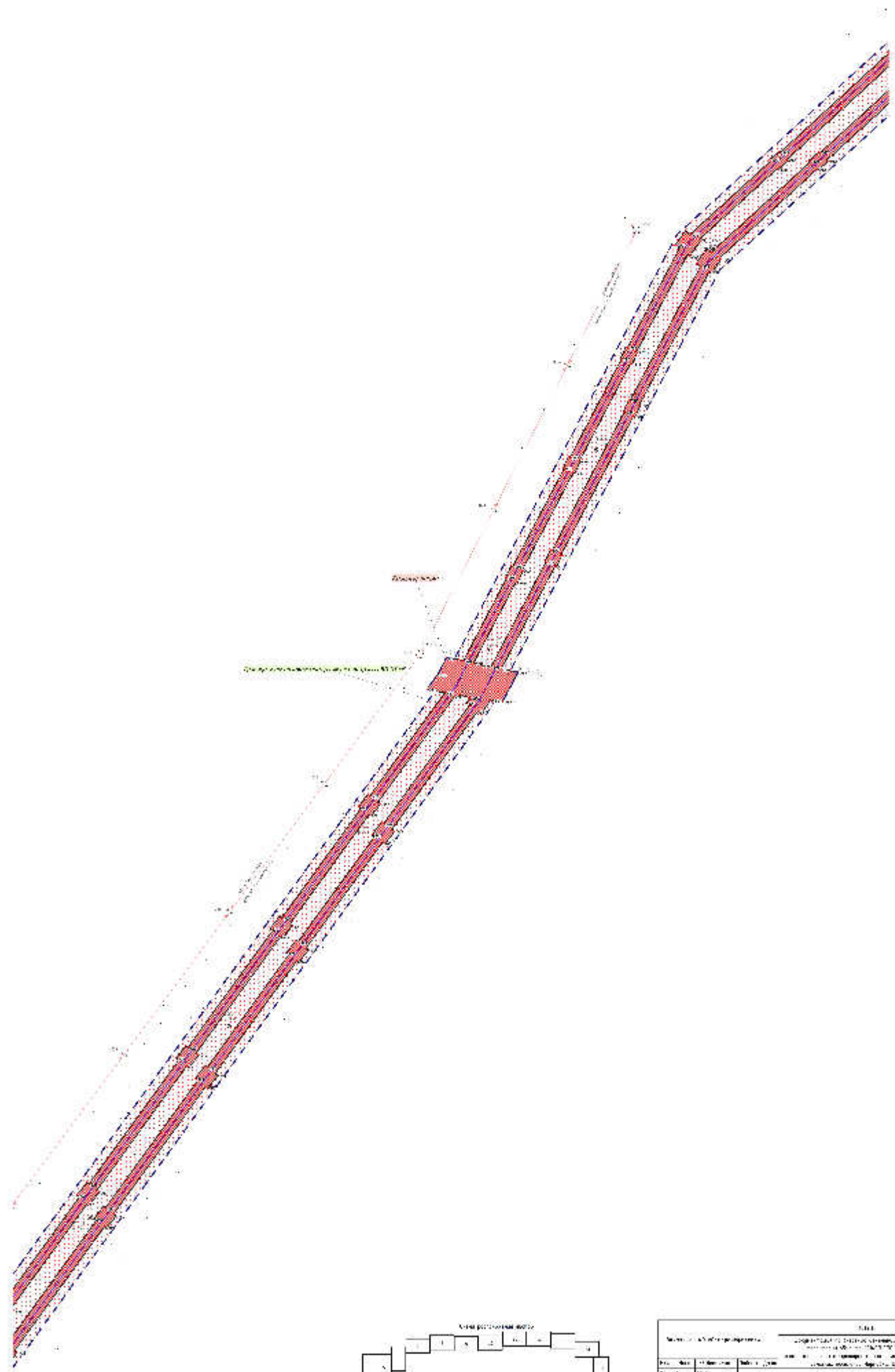

Project Information		Contract Information	
Project No.	2014/04/0000000	Contract No.	14-0000000
Project Name	Interchange at Exit 10, I-76/US-22	Contract Description	Construction of Interchange at Exit 10, I-76/US-22
Project Location	Exit 10, I-76/US-22, New Jersey	Contract Start Date	08/01/2014
Project Status	Under Construction	Contract End Date	07/31/2015
Project Manager	John Doe	Contract Administrator	Jane Smith
Project Engineer	John Doe	Contract Value	\$10,000,000

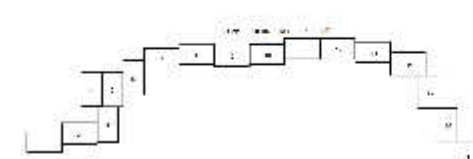
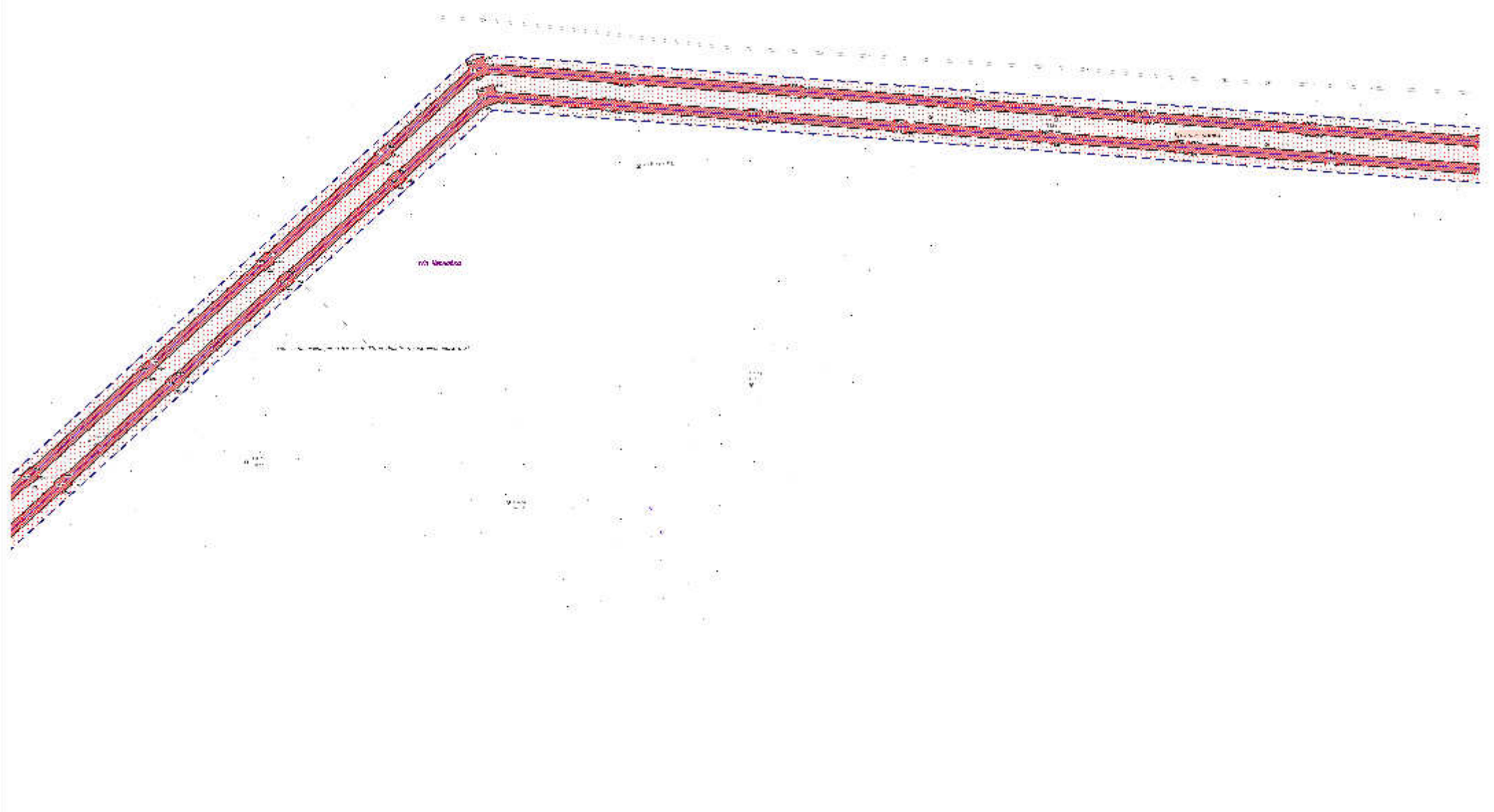

Model: 3D-Compensation			Title		
Level: 01	01/01/2014	01/01/2014	3D-Compensation		
Level: 02	01/01/2014	01/01/2014	3D-Compensation		
Level: 03	01/01/2014	01/01/2014	3D-Compensation		
Level: 04	01/01/2014	01/01/2014	3D-Compensation		
Level: 05	01/01/2014	01/01/2014	3D-Compensation		
Level: 06	01/01/2014	01/01/2014	3D-Compensation		
Level: 07	01/01/2014	01/01/2014	3D-Compensation		
Level: 08	01/01/2014	01/01/2014	3D-Compensation		
Level: 09	01/01/2014	01/01/2014	3D-Compensation		
Level: 10	01/01/2014	01/01/2014	3D-Compensation		

